

No.	Issue Name	Date

**Legend / Notes**

Architectural Square Footage	4142 Sq Ft 385 Sq M
Terrace Square Footage	614 Sq Ft 57 Sq M

This DD set is not coordinated with the following consultants:  
 - Lighting Designer  
 - Hospitality (Kitchen, Laundry, Spa)  
 - Interior Designer

**Design Development**

100% Submission

**Client:**  
 SC Property Acquisition, LLC  
 176 NE 43 Street  
 Miami, Florida 33137 USA  
 Tel: +1(305) 571 8228  
 Fax: +1(305) 576 1822

**Architects:**  
 Richard Meier & Partners, Architects LLP  
 475 Tenth Avenue, 6th Floor  
 New York, New York 10018 USA  
 Tel: +1(212) 967 6060  
 Fax: +1(212) 967 3207

**In Collaboration with:**  
 Kobi Karp Architecture and Interior Design, Inc.  
 2915 Biscayne Boulevard, Suite #200  
 Miami, Florida 33137 USA  
 Tel: +1(305) 573 1818  
 Fax: +1(305) 573 3766

**Structural Engineer:**  
 DeSimone Consulting Engineers  
 800 Brickell Avenue, 6th Floor  
 Miami, FL 33131  
 Tel: +1 (305) 441-0755  
 Fax: +1 (786) 383-2329

**MEP Engineer:**  
 Steven Fuller P.E., Inc.  
 500 N.E. Third Avenue  
 Fort Lauderdale, FL 33301  
 Tel: +1 (954) 467-1402  
 Fax: +1 (954) 467-5752

**Landscape Designer:**  
 Fernando Wong Outdoor Living Design  
 1504 Bay Road, Suite 2705  
 Miami Beach, FL 33139  
 Tel: +1 (305) 321-0546

**Landscape Architect of Record:**  
 EDSA  
 1512 E. Broward Boulevard, Suite 110  
 Fort Lauderdale, FL 33301  
 Tel: +1 (954) 524-3330  
 Fax: +1 (954) 524-0177

**Surf Club**

Miami, Florida

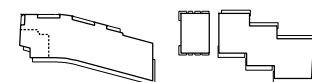

**South Condo  
 Unit A  
 Floors 4-7**

Date	18 October 2013	Sheet No.	<b>I-101</b> SA
Scale	1/8" = 1'-0"		
Project	12140		