

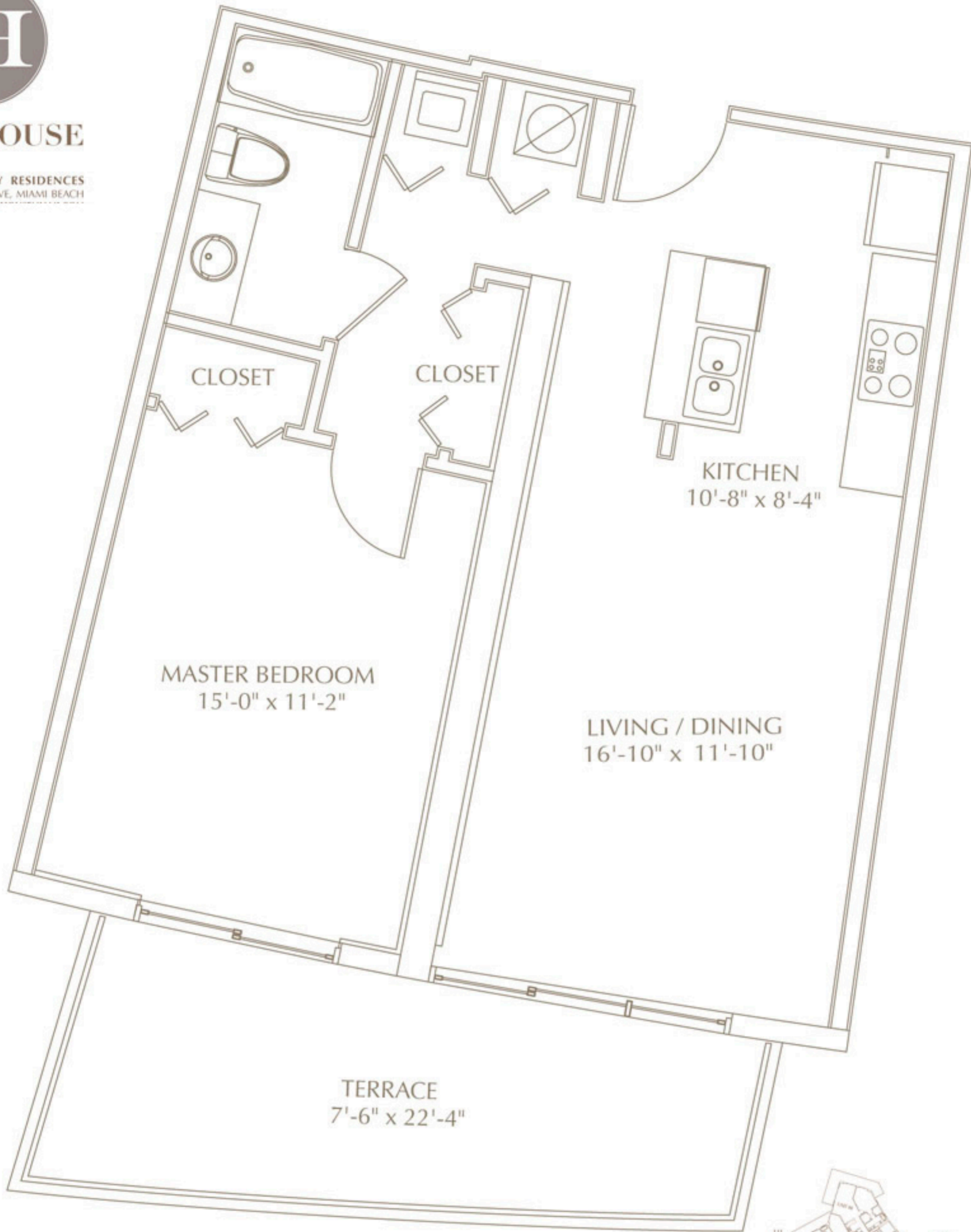

# EDEN HOUSE

BOUTIQUE LUXURY RESIDENCES  
6700 INDIAN CREEK DRIVE, MIAMI BEACH



## 1 BEDROOM, 1 BATH & FAMILY ROOM

|                   |                    |                         |
|-------------------|--------------------|-------------------------|
| ENCLOSED AREA     | 700 SQ. FT.        | 65 m <sup>2</sup>       |
| TERRACE AREA      | 167 SQ. FT.        | 16 m <sup>2</sup>       |
| <b>TOTAL AREA</b> | <b>867 SQ. FT.</b> | <b>81 m<sup>2</sup></b> |



ORAL REPRESENTATIONS CANNOT BE RELIED UPON AS CORRECTLY STATING REPRESENTATIONS OF THE DEVELOPER. FOR CORRECT REPRESENTATIONS, MAKE REFERENCE TO THE DOCUMENTS REQUIRED BY SECTION 718.503, FLORIDA STATUTES, TO BE FURNISHED BY A DEVELOPER TO A BUYER OR LESSEE. All dimensions are approximate and all floor plans and development plans are subject to change. This floor plan represents the typical floor plan for the residence type indicated and is provided for informational purposes only. The actual floor plan of the residence may differ. The features and amenities depicted herein are based upon current development plans, which are subject to change without notice. All dimensions are taken to the outside finished surface of the exterior walls, and to the centerline of interior demising walls, and vary from the dimensions that would be determined based upon the description of the "Unit" set forth in the Declaration of Condominium (which generally includes only the interior airspace between the unfinished interior surfaces of the walls bounding the unit).

# RESIDENCE 03

LEVELS 5TH - 15TH