

ATLANTIC OCEAN

COLLINE AVENUE
KEY PLAN
N.T.S.

SOUTH TOWER (Levels 04-11)
UNIT 'B' MOD
3 BEDROOMS AND 3 1/2 BATHS

A/C	3,133 SQ FT	291.1 M ²
BALCONY	1,008 SQ FT	93.6 M ²
TOTAL	4,141 SQ FT	384.7 M ²

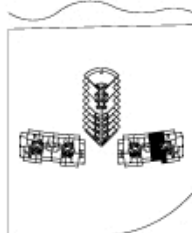

Overall dimensions are measured to the exterior face/line of the exterior walls, the centerline of exterior demising walls between units, and the outer boundary of exterior demising walls adjacent to common elements, and to face tops for the dimensions that would be determined by using the description and definition of the "floor" set forth in the Declaration. Such dimensions generally only include the linear distances between the perimeter walls and vertical structure components. All dimensions are approximate, and all floor plans and development plans are subject to change. The architect, contractor, general contractor, plans, specifications, terms, conditions and statements contained in this brochure are prepared and presented only for the use and are not necessarily related to their plans and specifications for the development. Further, Developer reserves the right to modify, delete or substitute any or all the same in its sole discretion and without prior notice.