

**UNIT A**

2	BEDROOMS	2	BATHROOMS
INTERIOR	1,904 SF	177 M	
TERRACE	169 SF	16 M	
<b>TOTAL</b>	<b>2,073 SF</b>	<b>193 M</b>	

17201 BISCAYNE BOULEVARD, NORTH MIAMI BEACH, FL 33162

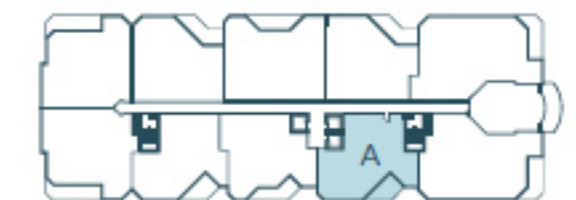

N  
KEY PLAN - UNIT LOCATION

All dimensions are approximate and all floor plans and development plans are subject to change. This floor plan represents the typical floor plan for the residence type indicated and is provided for informational purposes only. The actual floor plan of the residence may differ. All features listed for the residences are representative only, and the Developer reserves the right, without notice to or approval by the Buyer, to make changes or substitutions of equal or better quality for any features, materials and equipment. All dimensions are taken to the outside finished surface of the exterior walls, and to the centerline of interior demising walls, and vary from the dimensions that would be determined based upon the description of the "Unit" set forth in the Declaration of Condominium (which generally includes only the interior airspace between the unfinished interior surfaces of the walls bounding the unit). All sketches, renderings, graphic materials, plans, specifications, terms, conditions, and statements contained in this brochure are proposed and conceptual only and do not necessarily reflect the final plans and specifications for the development. Further, developer reserves the right to modify, revise, or withdraw any or all of sale in its sole discretion and without prior notice.