

RIVAGE

BAL HARBOUR

RESIDENCE

B

FLOORS

18-21

4 BEDROOMS
6 BATHROOMS
POWDER ROOM
OFFICE / BEDROOM
FAMILY ROOM
SERVICE

INTERIOR
5,810 SF | 540 SQM

EXTERIOR
485 SF | 45 SQM

TOTAL
6,295 SF | 585 SQM

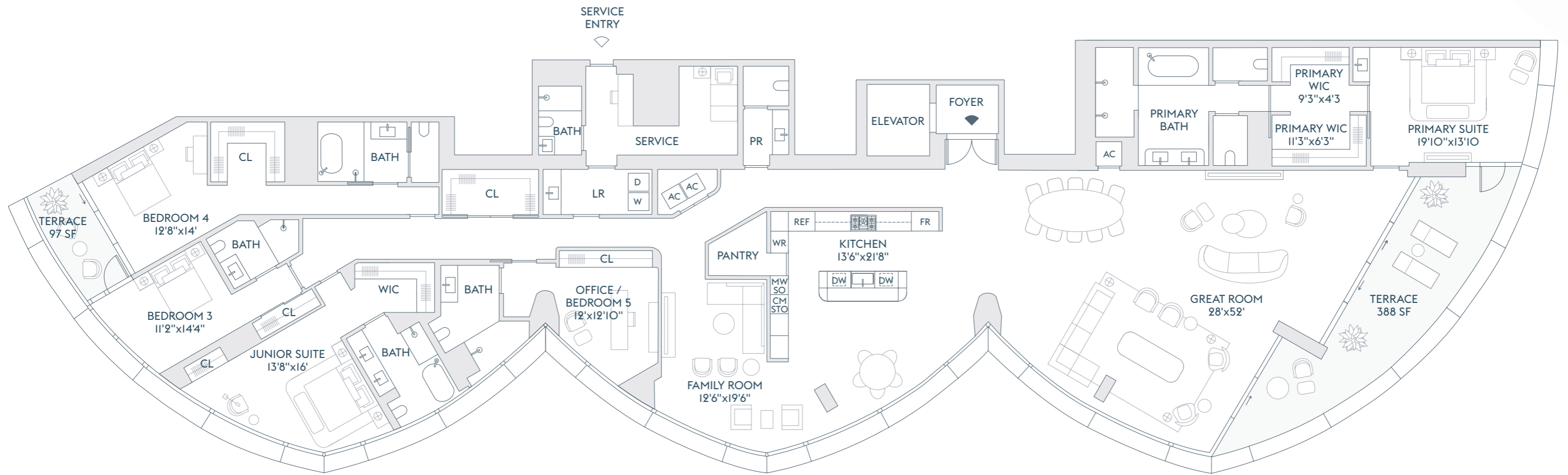

INTRACOASTAL
WATERS

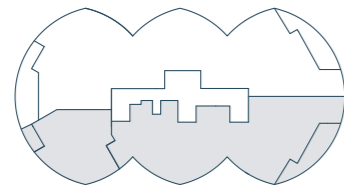

ATLANTIC OCEAN

ALTERNATE PRIMARY BEDROOM

The dimensions stated for this floor plan are approximate because there are various recognized methods for calculating the square footage of a unit. The square footage stated here is calculated from the exterior boundaries of the exterior walls to the centerline of interior demising walls without deductions for cutouts, curves, or architectural features. This method typically results in quoted dimensions greater than the dimensions that would be determined by using other accepted methods. The definition of "Unit" and the calculation method to be relied upon is set forth by the Developer in Developer's prospectus which method may result in a square footage calculation less than the result of the calculation method used here. Renderings depict features not included with purchase, but which are available at an additional cost such as wine bar and closet millwork among others. Consult the Developer's prospectus to learn what is included with Unit purchase and to understand Unit dimensions. 2024 © Carlton Terrace Owner LLC, with all rights reserved.