

NOBE PARC

MIAMI BEACH

Line 7

Levels 5-14

2 BEDROOMS + DEN / 2 BATHS

| | | |
|--------------|----------------------|--------------------------|
| Interior | 848 sq. ft. | 79 m ² |
| Terrace* | 305 sq. ft. | 28 m ² |
| Total | 1,155 sq. ft. | 107 m² |

* Levels 5, 10 & 12 Terrace is 232 sq. ft.
Level 8 Terrace is 8 sq. ft.

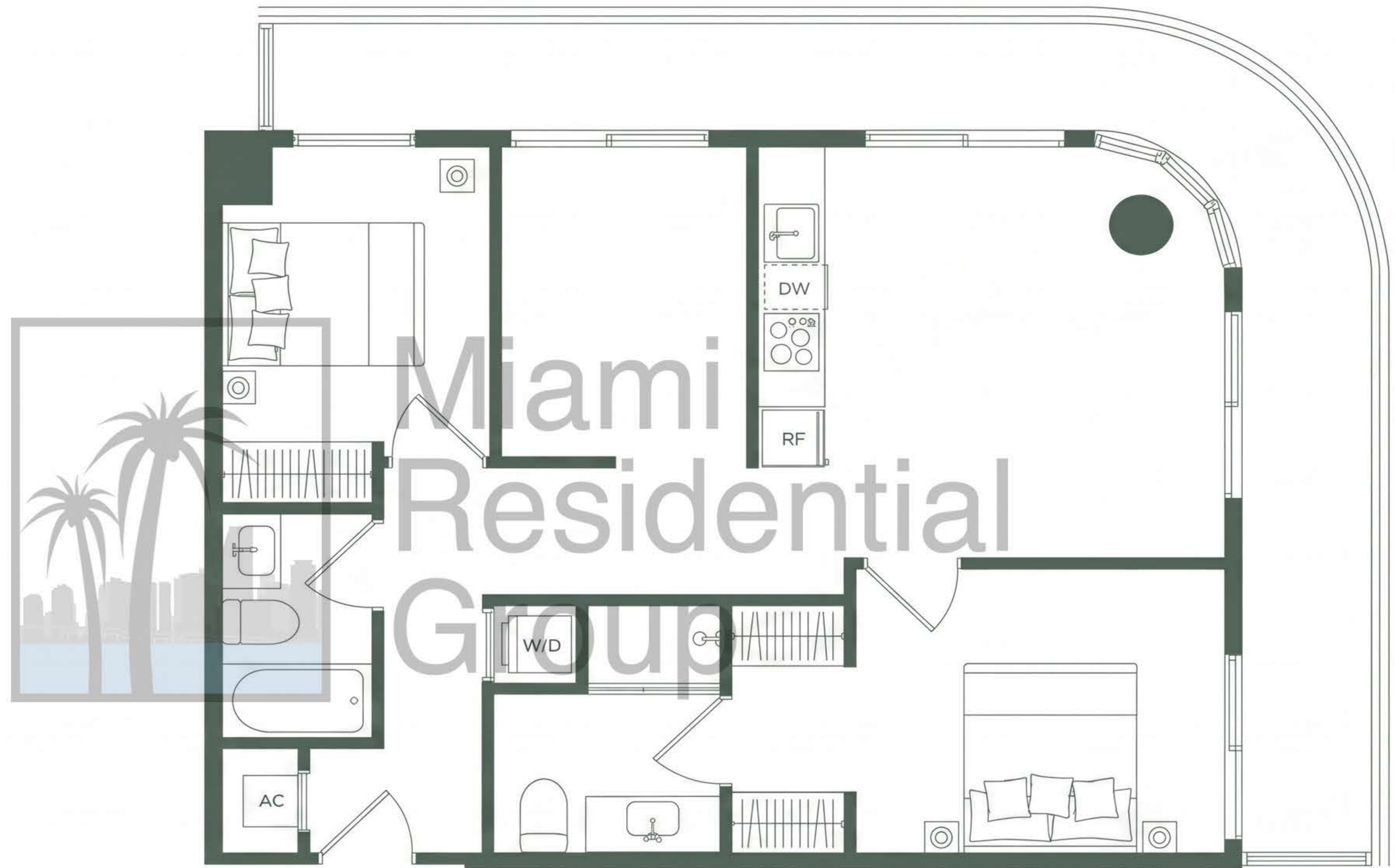
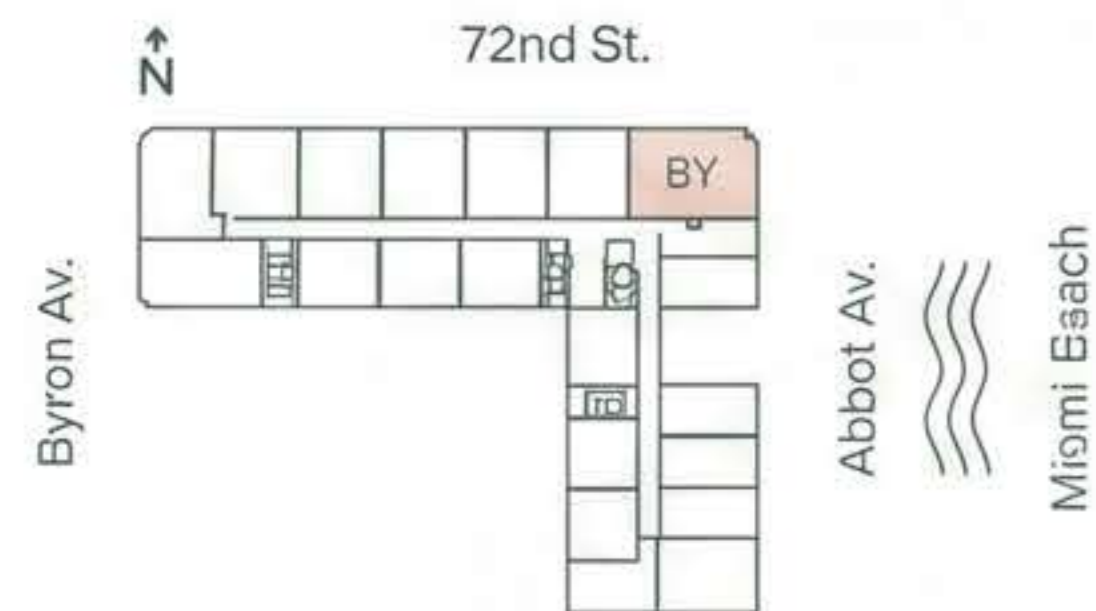

ONEWORLDSM ROBERT FINVARB COMPANIES

 OHAL REPRESENTATIONS CANNOT BE DELIED UPON AS CORRECTLY DURING THE REPRESENTATIONS OF THE DEVELOPER. FOR CORRECT REPRESENTATIONS. WARE REFERENCE TO THIS BBOCHURE AND TO THE DOCUMENTS REQUIRED BY SENTION 716.86if, FLORIDA STATUTES. TO BE FURNISHED BY A GEVEL- OPEN TO A SUVER OR LPESEE. There are pzoucs eaaygared mahinde for sderdering the separe bartage of a cleit. The coypore terrage and dencentiss tuntest hozorm are reppoured to the sstatet sapianzsrce of the sabittra arets and dre cemartins of lelwois oitashng wnils ant in frat wirty item the dexsodktars anal would be derpenined by using the descric- tion and definition of the "Unit" set lzrrit in the Declaration porlth generally only includes the interior anepsoe between the parrealter crfts and eaclutes interior strestural components). For sour reference, the area of the Unit, determined in determiness aith these doficed unit bouriozoles, is set haitt in the Deslaration. Note that measurements of romps got bath on for item ptin ure preupratt strom of the grastiot green of each plaon vawn (pa if the room vnois s. inlust poviengife, without raqoid for any inlcuots. Asvertingly, the ures of the etual netar oit icnually be mraiter than the preduct poafaced by these definout olfnod datest ireuocianes. The maueilerars and sapere fronsgo wilsted for this uife lfor pion ean exprestment and may vary with chical construction, and all Feor plans and development skers are subject to change. All dexplotions of formilnigs, appliances, tzull-iltx, noulmees, svils, flour coverlorg, lighting and other matters of sintor, including, without findation, items of Fesh and deperation, are conceptual only and are not necessaily included in each Unit. Contaut the Developer's prospetsto for information on what is offered with the Unit.