

NOBE PARC

MIAMI BEACH

Line 20

Levels 6 -14

Jr 1 BEDROOM / 1 BATH

Interior	375 sq. ft.	35 m ²
Terrace*	101 sq. ft.	9 m ²
Total	476 sq. ft.	44 m²

*Levels 6, 8, 10 & 12 Terrace is 90 sq. ft.



Miami Residential Group

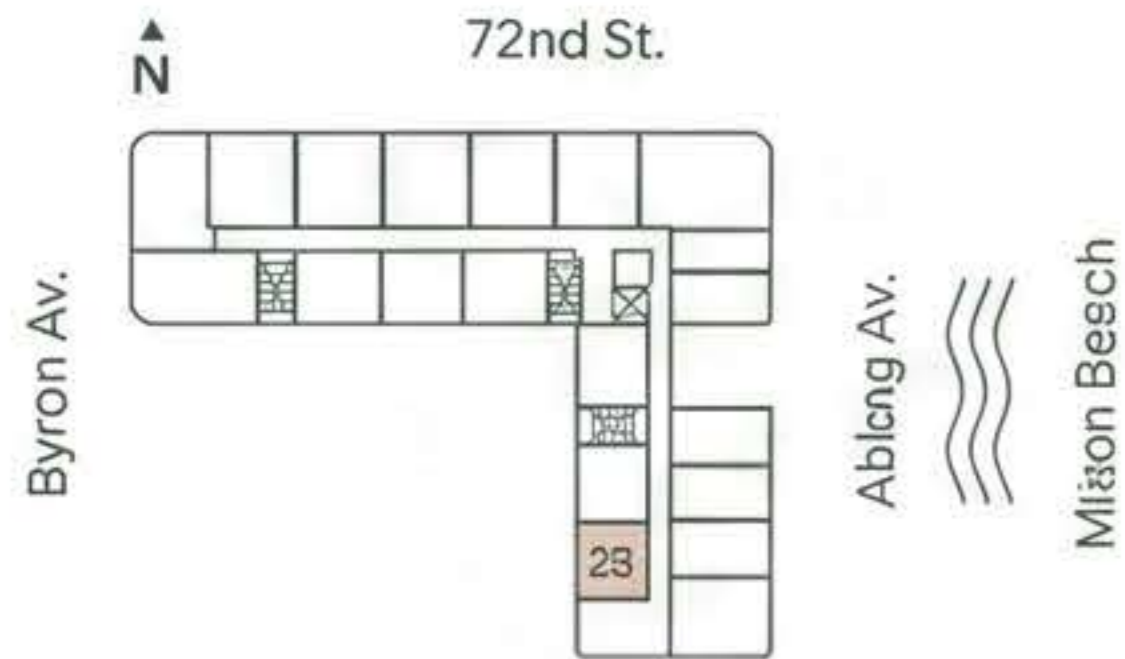
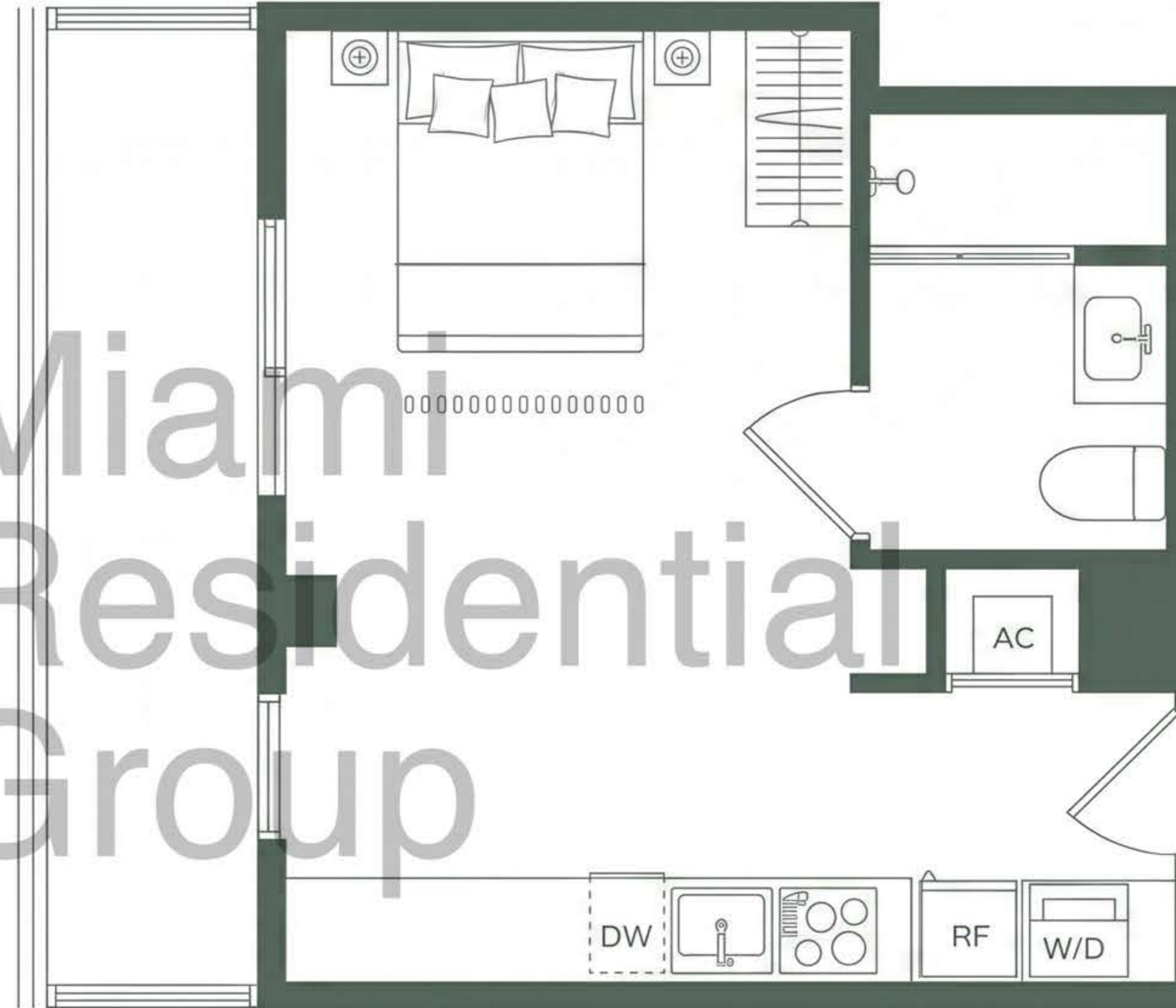

ORAL REPRESENTATIONS CANNOT BE RELIED UPON AS CORRECTLY STATING THE REPRESENTATIONS OF THE DEVELOPER, FOR CORRECT REPRESENTATIONS, MAKE REFERENCE TO THIS BROCHURE AND TO THE DOCUMENTS REQUIRED BY SECTION 718.568, FLORIDA STATUTES, TO BE FURNISHED BY A DEVELOPER TO A BUYER OR LESSEE. There are many common methods for calculating the square footage of a Unit. The square footage and dimensions stated herein are measured to the exterior boundaries of the exterior walls and the perimeter of interior doming radius and in fact vary from the dimensions that would be determined by using the description and dimensions of the "Gross" area in the Declaration currently used includes the major spaces across the center wall and includes interior element component. For your reference, the area of the Unit, oriented in accordance with those unit declaration, is set forth in the Declaration. Note that in some cases of rooms set forth on this floor plan are generally based at the greatest point of each given room (as if the room were a perfect rectangle), without regard for any cutouts. Accordingly, the area of the actual room will typically be smaller than the product obtained by multiplying the stated length times width. The dimensions and square footage stated for the Unit floor plan are approximate and may vary with actual construction, and of floor plans and development plans are subject to change. All depictions of furnishings, appliances, built-ins, counters, soffits, floor coverings, lighting and other matters of detail, including, limited liability, terms of title and decoration, are conceptual only and are not necessarily offered in each Unit. Consult the Developer's prospectus for information on this offering.